

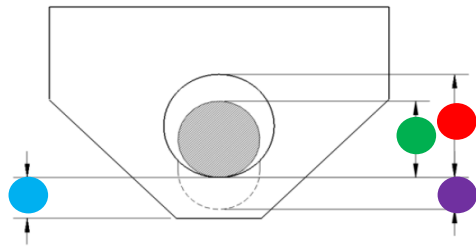

**Buddy Bushing Plate Construction Description**

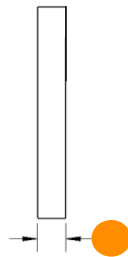

Single Plate Construction



Two Angle Construction

Part Number	Diameter of Hole	Diameter of Hardware	Amount of Wear in	Bottom of Original Hole to Bottom Edge	Total Plate Thickness	Vertical Load	Longitudinal Load	Transverse Load
71395	0.9375	0.625	-	1	0.75	560	4000	50
68179	1.25	0.75	0.5	0.625	-	3500	1500	500
68167	1.25	0.75	0.5	0.625	0.375	3500	500	1500
71537	1.25	0.75	0.75	0.75	0.375	1218	0	1096
68166	1.25	0.75	0.5	0.625	0.5	3500	500	1500
72201	1.25	0.75	0.5	0.5	0.5	1064	0	926
67497	1.3125	0.75	0.125	0.75	0.5	4000	2000	1500
68102	1.4375	-	-	-	-	4150	0	1800
68976	1.4375	0.75	0.4	0.625	0.625	-	-	-
70500	1.4375	0.75	0.25	0.54	0.625	650	200	730
69295	1.5	0.625	0.5	0.75	0.375	9000	2000	700
68703	1.5	0.75	0.625	1	0.5	4300	0	0
72834	1.75	0.875	0.25	0.875	0.375	LC1 4884 LC2 9793 LC3 3582	0 0 6434	3593 2803 709
67249	2	0.625	-	-	0.25	5250	0	0
72835	2	0.875	0.25	1	0.5	LC1 3967 LC2 11454 LC3 2909	0 0 6434	3549 2855 701
68724	2.5	0.625	0.25	1	0.75	8241	6426	3236